

Bimba Metric Flow Controls, FCPM Series

- Ease of Use:
 - Accepts Nylon or Polyurethane Tubing.
 - Corrosion Resistant Components.
 - Broad Catalogue Selection Plus Unique Customer Solutions.

Specifications

Fluid	Air
Maximum Operating Pressure	10 Bar (145 PSI)
Minimum Operating Pressure	0.1 Bar (1.5 PSI)
Temperature Range	-10° to +80°C (-14° to +176°F)

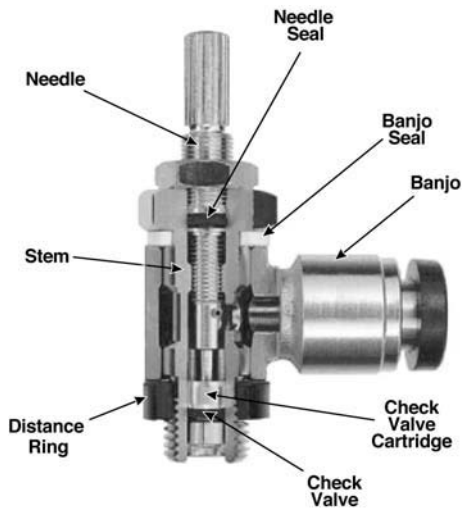

Material Specifications for G1/8" and G1/4"	
Banjo	Nickel Plated Brass
Stem	Nickel Plated Brass
Needle	Nickel Plated Brass
Check Valve	NBR (Buna-N)
Check Valve Cartridge	Brass
Needle Seal	NBR (Buna-N)
Banjo Seal	Reinforced Nylon
Distance Ring	Reinforced Nylon

G1/8 Port Mounted Flow Control Valves



G1/8 Controlled Flow Chart (at 5 Bar)
Maximum Free Flow Capacity 110-334 l/min

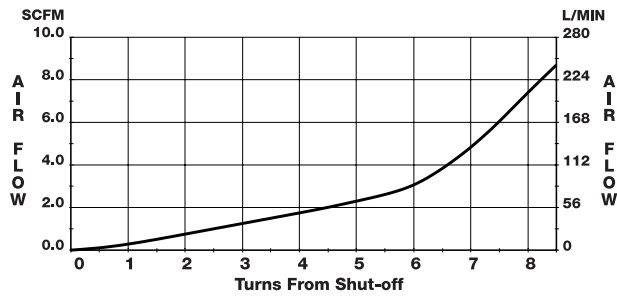

G1/4 Port Mounted Flow Control Valves



G1/4 Controlled Flow Chart (at 5 Bar)
Maximum Free Flow Capacity 394-634 l/min

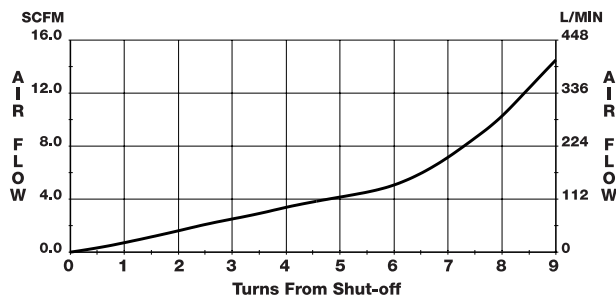

For G1/8 port,
FCPM-2-Q4-L
 4mm OD tubing
 2mm ID tubing

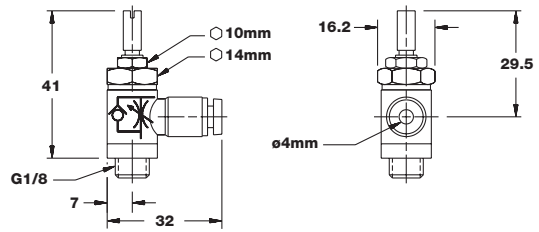

For G1/8 port,
FCPM-2-Q4-R
 4mm OD tubing
 2mm ID tubing

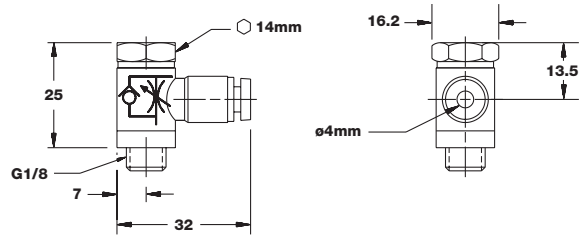

For G1/8 port,
FCPM-2-Q6-L
 6mm OD tubing
 4mm ID tubing

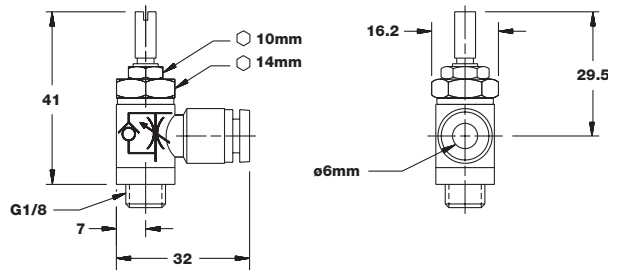

For G1/8 port,
FCPM-2-Q6-R
 6mm OD tubing
 4mm ID tubing

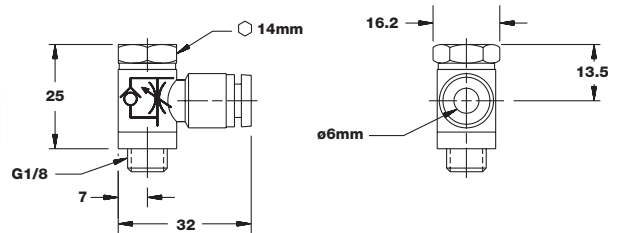

For G1/8 port,
FCPM-2-Q8-L
 8mm OD tubing
 6mm ID tubing

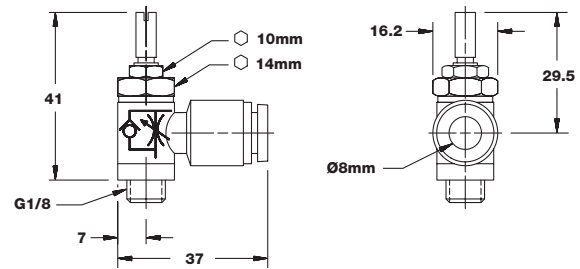

For G1/8 port,
FCPM-2-Q8-R
 8mm OD tubing
 6mm ID tubing

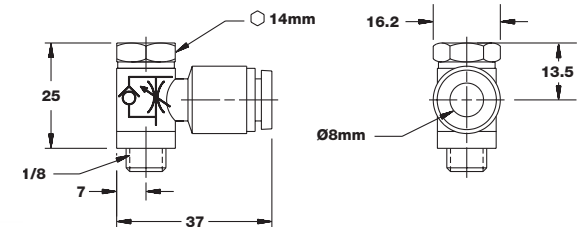

For G1/4 port,
FCPM-4-Q6-L
 6mm OD tubing
 4mm ID tubing

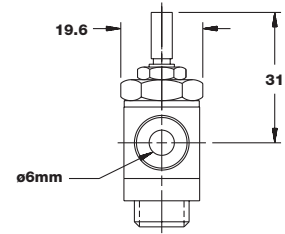
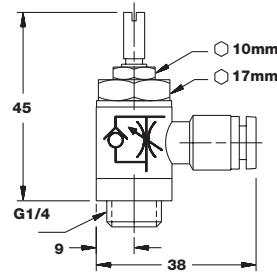

For G1/4 port,
FCPM-4-Q6-R
 6mm OD tubing
 4mm ID tubing

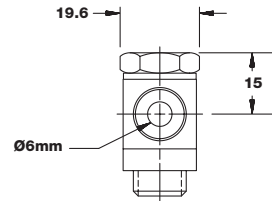
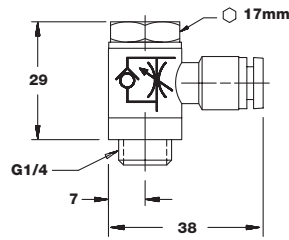

For G1/4 port,
FCPM-4-Q8-L
 8mm OD tubing
 6mm ID tubing

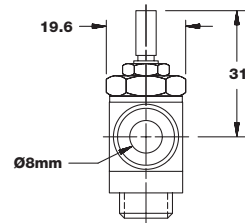
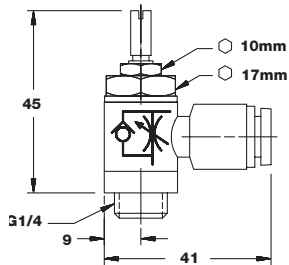

For G1/4 port,
FCPM-4-Q8-R
 8mm OD tubing
 6mm ID tubing

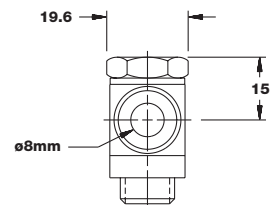
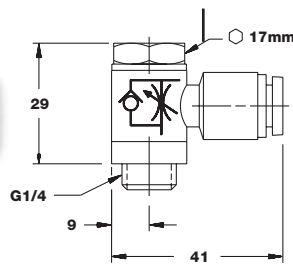

ISO 6431

ISO 6432

Flat

Pneu-Turn

Ultram

Flow Control

Position Sensing Solutions

